

Electrical Specifications

- | | |
|------------------|------------------|
| • Input Voltage | 12~57 VDC (Max.) |
| • Output Voltage | 12~57 VDC (Max.) |
| • Max. Current | 1.5 A |

Physical Specifications

- | | |
|----------------------|------------------------|
| • Ports | PoE and LAN (2 x RJ45) |
| • Ethernet Data Rate | 10/100 Mbps |
| • Data Pins | 1/2 & 3/6 |
| • Power Pins | 4/5 & 7/8 |
| • DC input | 2.1x 5.5 mm DC jack |
| • LED Indicator | Power |
| • Color | Black |
| • Dimensions | 51 x 25 x 26.5 mm |
| • Weight | 25 g |

Environmental Specifications

- | | |
|-------------------------|-------------------------------|
| • Operating Temperature | 0 °C to +40 °C |
| • Storage Temperature | -20 °C to +65 °C |
| • Operating Humidity | 10 to 80% (Non-condensing) |
| • Storage Humidity | 5 to 90% (Non-condensing) |

Connection Diagram



Product Ordering Information

- DC Injector with LED for C1n Series

Contact Us

- Email: sales@altaitechnologies.com

PE-PB-170727

Although Altai has attempted to provide accurate information in these materials, Altai assumes no legal liability for the accuracy and completeness of the information. All specifications are subject to change without notice.

Input Specifications

- AC Input Voltage 90 – 264 VAC (Max.)
100 – 240 VAC (Nominal)
- AC Input Frequency 47 – 63 Hz (Max.)
50 Hz/60 Hz (Nominal)
- AC Input Current 500 mA (Max.)

Output Specifications

- Output Voltage 17.1 – 18.9 VDC (Max.)
18 VDC (Nominal)
- Output Current 660 mA (Max.)
- Output Ripple 150 mV

Protection Specifications

- Over Voltage Protection
- Over Current Protection
- Short Circuit Protection

Energy Efficiency Specifications

- Energy Efficiency Marking V
- No Load Power 0.3 W (Max.) at Input 115 V
60 Hz/ 230 V 50 Hz
- Average Efficiency 77.69% (Min.) at Input 115 V
60 Hz/ 230 V 50 Hz, Rated
Output 18 VDC, 660 mA,
11.88 VA
- Standards Europe: ErP/ EuP
USA: EISA/CEC/Energy Star

Environmental Specifications

- Operating Temperature -10 °C to +50 °C
- Storage Temperature -20 °C to +70 °C
- Operating Humidity 10 to 95%
- Storage Humidity 10 to 95% (Non-condensing)

Mechanical Specifications

- Dimensions 75 x 50 x 32 mm
- Mounting Wall-mounted
- Power Line Cord UL2468 2/AWG 24 with
Female Plug, Ø5.5 x Ø2.1 x
10 mm x1800 mm ±10%

Safety Specifications

- Dielectric Strength 3000 VAC at 1 second,
(Hi-pot) Cutoff current 10 mA
- Leakage Current 250 µA (Max.) at 250 Vrms
- Insulation Resistance 5 MΩ (Min.) at 500 VDC

Reliability Specifications

- MTBF 50,000 hours (Min.) at Max.
Rated Load and 25°
Ambient Temperature

Safety Standards

- CE Europe IEC/EN60950-1
- UL USA UL/CSA 60950-1

EMC Standards

- FCC Part 15 subpart B, ICES-003
- EN55022, EN55024, EN61000-3-2/3
- EN55013, EN55020, EN61000-3-2/3
- EN61204-3, EN61000-3-2/3
- EN55014-1, EN55014-2, EN61000-3-2/3
- EN55015, EN61547, EN61000-3-2/3
- UL/CSA 60950-1, UL/CSA 60065, UL1310, UL697,
CSA C22.2 No. 223, CSA-C22.2 No. 173, UL8750
- IEC/EN60950-1, AS/NZS60950-1
- IEC/EN60065, AS/NZS60065
- IEC/EN61558-1+IEC/EN61558-2-7
- IEC/EN61558-2-16, IEC/EN61558-2-17
- AS/NZS61558-2-16, AS/NZS61558-2-17
- IEC/EN60335-1, AS/NZS60335-1
- IEC/EN61347-2-2, AS/NZS61347-2-2, IEC/EN61347-2-13,
AS/NZS61347-2-13

Dimensions Diagram

AC Adaptor Body

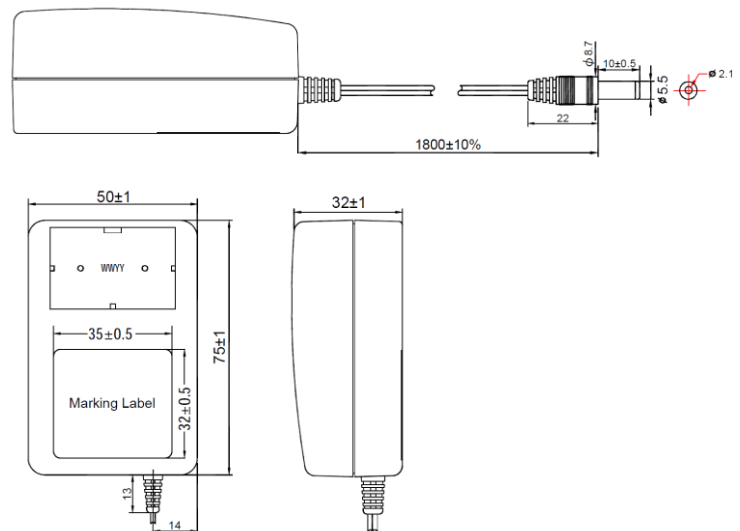

Adaptor Plug

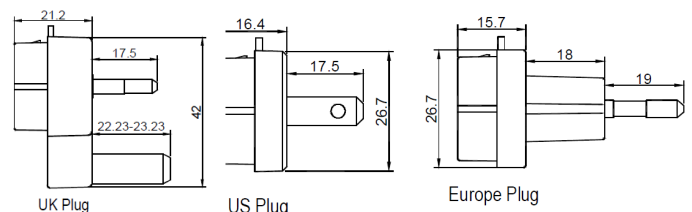

Product Ordering Information

- 18VDC AC Adaptor

| Type of plug | Part No. |
|--------------|---------------|
| US | SD.PE-0005-GP |
| UK | SD.PE-0006-GP |
| Europe | SD.PE-0007-GP |

Contact Us

- Email: sales@altaitechnologies.com

18DPE-GP-221115

Although Altai has attempted to provide accurate information in these materials, Altai assumes no legal liability for the accuracy and completeness of the information. All specifications are subject to change without notice.