

## Plug RJ45 6A Manual de Instalación

JACK DESIGNATION	PIN	TIA/EIA T568A	TIA/EIA T568B	INDUSTRIAL
		1	White/ Green	White/ Orange
2	Green	Orange	Orange	
3	White/ Orange	White/ Green	White	Blue
4	Orange	Green	Blue	Blue
5	Blue	Blue	White/ Blue	
6	White/ Blue	Blue	White/ Blue	
7	White/ Brown	White/ Brown	White/ Brown	
8	Brown	Brown	Brown	

- ① Remove the stopper before installation.

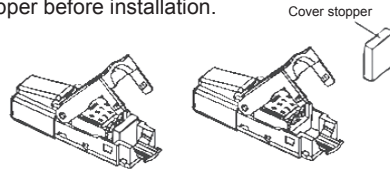

- ② Insert cable into strain relief boot, strip off 1.2 Inch of cable jacket, fold back braid and drain wire.

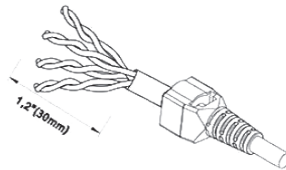

Boot adjustment  
Cut the end of boot to fit your cable OD

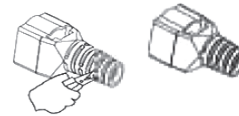

- ③ Fan out all four twisted pairs, following the color coding label and allocate each conductor into proper slots on wiring cap. Trim the ends of conductors.

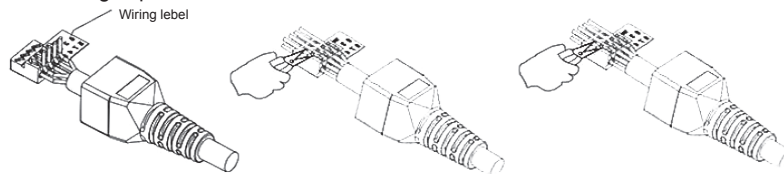

- ④ Place wiring cap on plug.

- ⑤ Place wiring cap on to plug, use plier camp wiring cap until it completely snap-in to effect the connection.

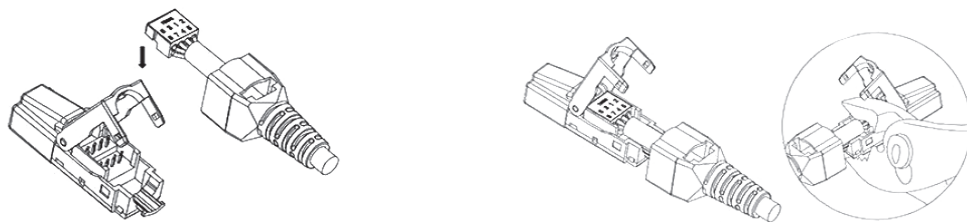

- ⑥ Close plug cover, make sure the drain wire is in proper contact with grounding clip on plug. pull back strain relieve boot to cover the plug, fasten supplied cable tie to secure grounding contact.

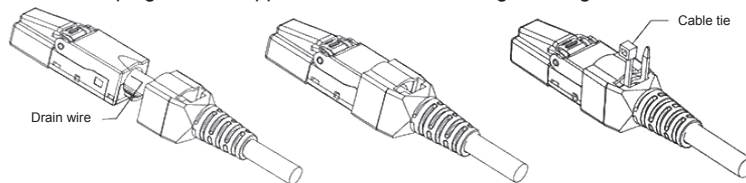

Unload the cable

Cut off cable tie, remove the boot. Using flat screwdriver and pry gently on plug cover one end first and the other end subsequently to open it.

